



# DOSSIER TECHNIQUE

## SOMMAIRE

Porte Panneau.....	page 2
Panneau coupes verticales & horizontales.....	page 3
Panneau section latérale.....	page 4
Panneau section seuil.....	page 5
Porte Monobloc.....	page 6
Monobloc coupes verticales et horizontales.....	page 7
Monobloc section latérale.....	page 8
Monobloc section seuil.....	page 9



# Coupe verticale

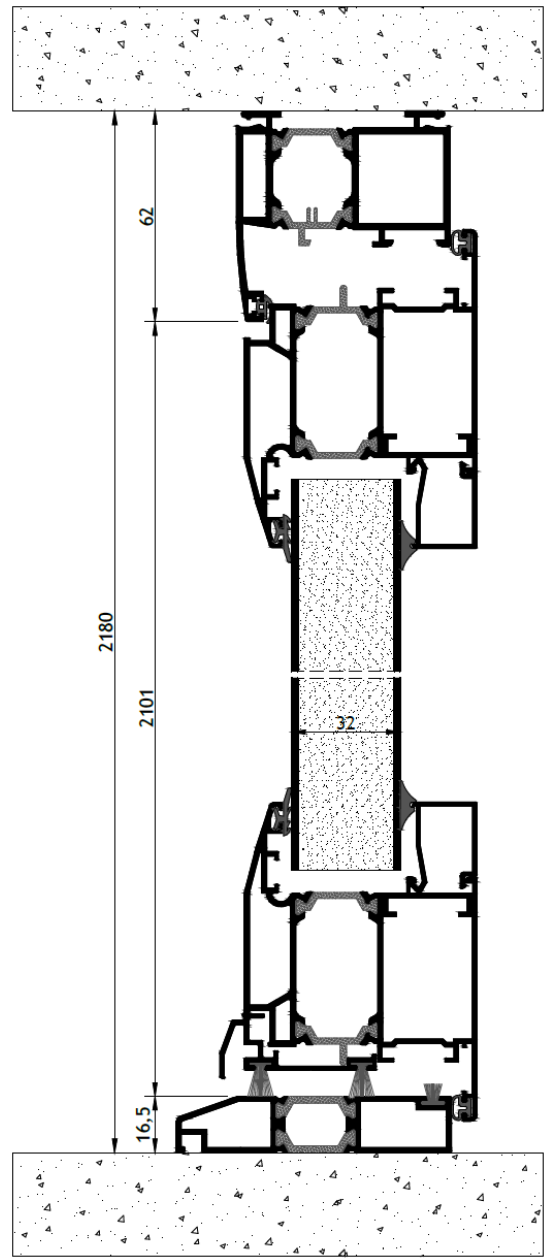

# Coupe horizontale

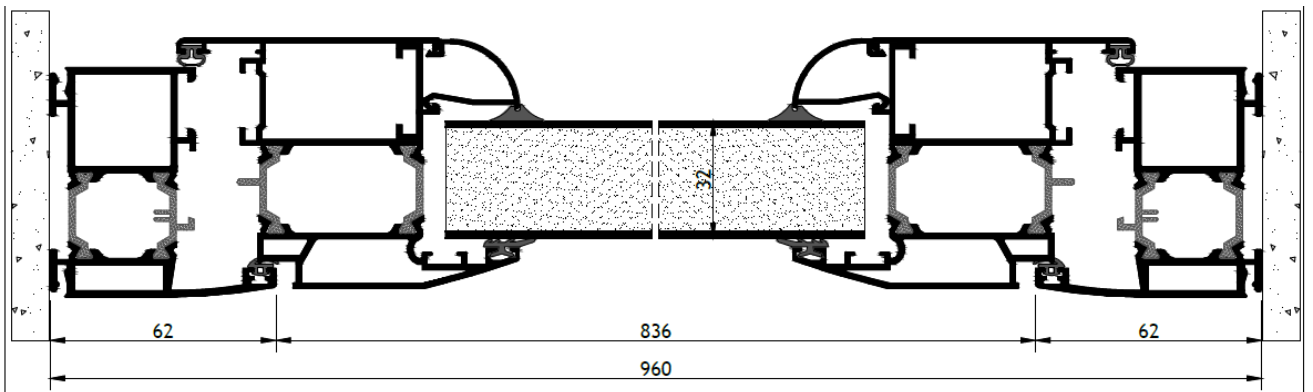

# Section latérale avec paumelle

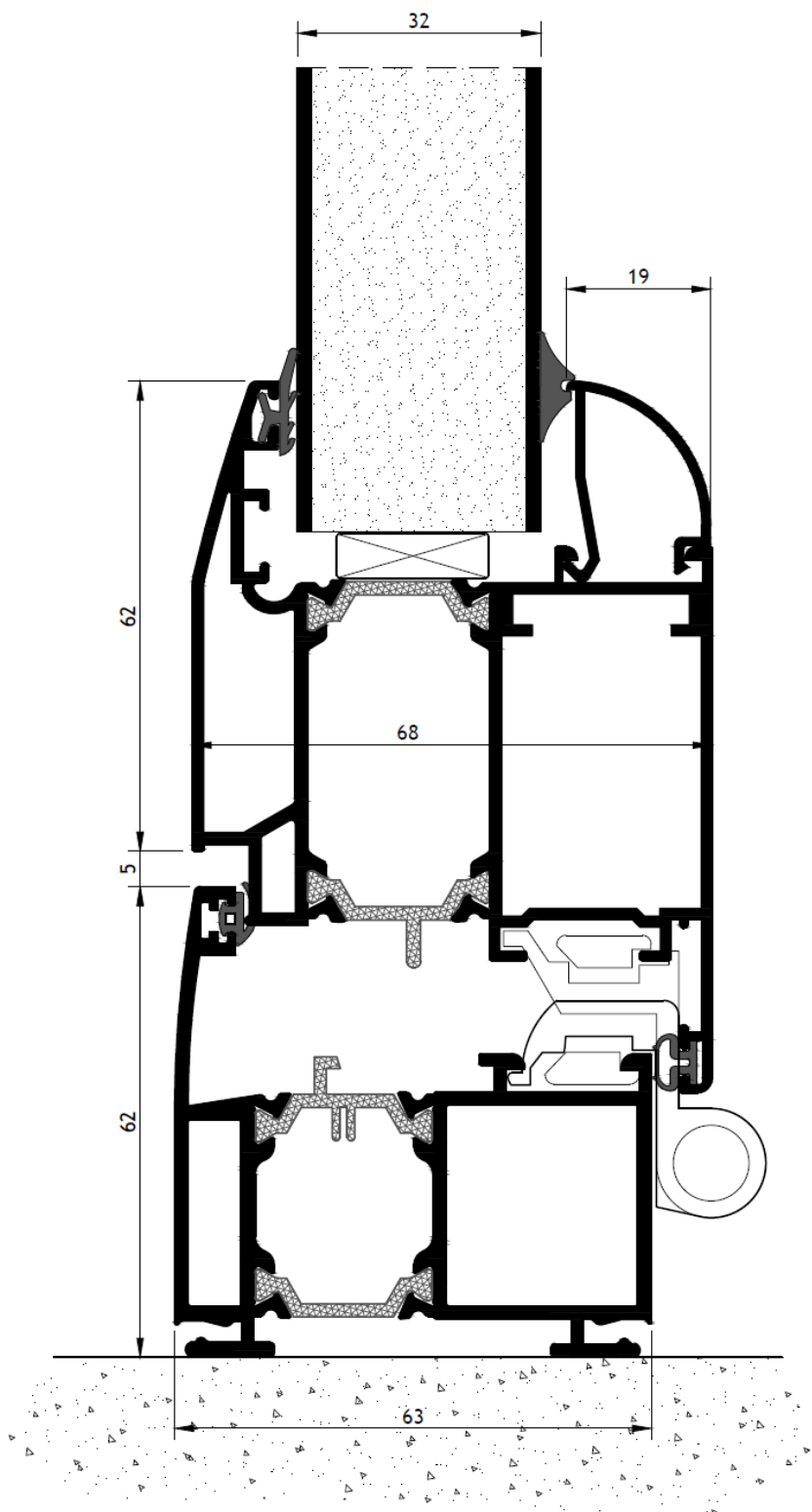

# Section seuil

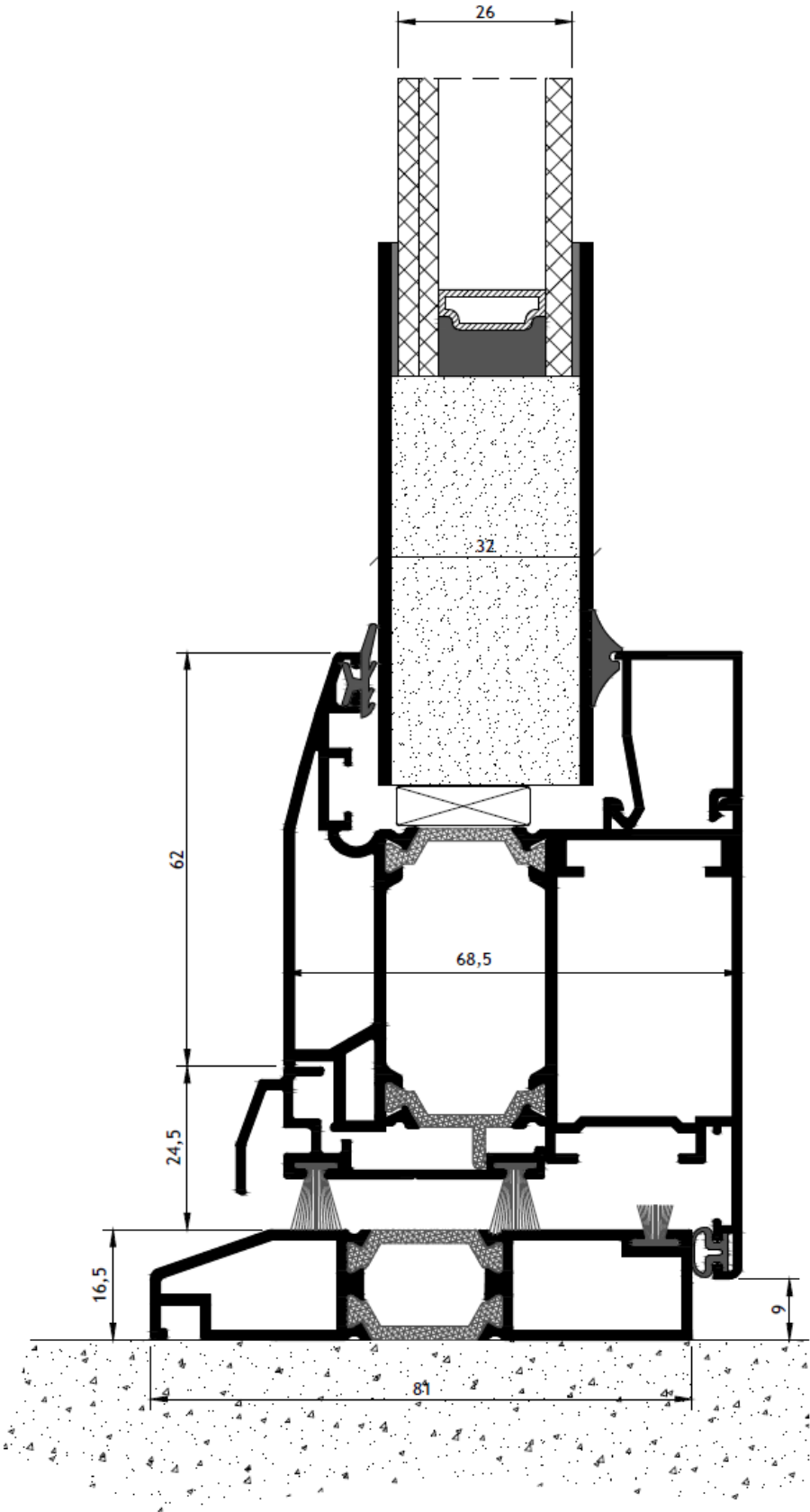





# Section latérale

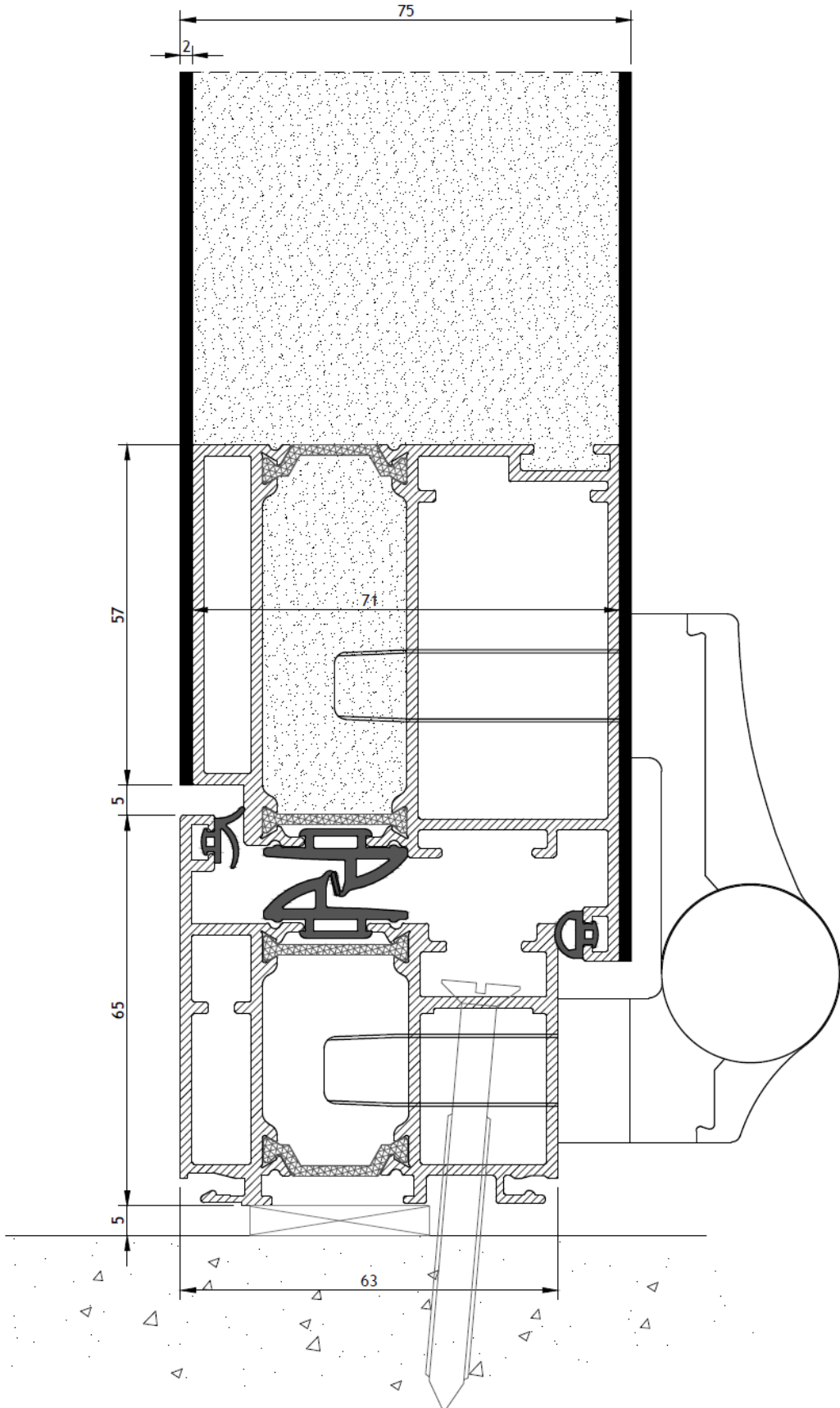



# Section seuil

